

# PRODUCT INFORMATION PACKET

**marathon**<sup>®</sup>  
Motors

Model No: 445TTDC16076  
Catalog No: GT0050  
125,1200,DP,445T,3/60/460PWS  
Open Drip Proof (ODP)



Regal and Marathon are trademarks of Regal Beloit Corporation or one of its affiliated companies.  
©2018 Regal Beloit Corporation, All Rights Reserved. MC017097E

**REGAL**<sup>®</sup>



### Nameplate Specifications

Output HP	<b>125 Hp</b>	Output KW	<b>93.0 kW</b>
Frequency	<b>60 Hz</b>	Voltage	<b>460 V</b>
Current	<b>145.0 A</b>	Speed	<b>1190 rpm</b>
Service Factor	<b>1.15</b>	Phase	<b>3</b>
Efficiency	<b>95 %</b>	Duty	<b>Continuous</b>
Insulation Class	<b>F</b>	Design Code	<b>B</b>
KVA Code	<b>G</b>	Frame	<b>445T</b>
Enclosure	<b>Drip Proof</b>	Overload Protector	<b>No</b>
Ambient Temperature	<b>40 °C</b>	Drive End Bearing Size	<b>6319</b>
Opp Drive End Bearing Size	<b>6317</b>	UL	<b>Recognized</b>
CSA	<b>Y</b>	CE	<b>Y</b>
IP Code	<b>12</b>		

### Technical Specifications

Electrical Type	<b>Squirrel Cage Inverter Rated</b>	Starting Method	<b>Part Wdg Start Or Inverter</b>
Poles	<b>6</b>	Rotation	<b>Reversible</b>
Mounting	<b>Rigid base</b>	Motor Orientation	<b>Horizontal</b>
Drive End Bearing	<b>Ball</b>	Opp Drive End Bearing	<b>Ball</b>
Frame Material	<b>Cast Iron</b>	Shaft Type	<b>T</b>
Overall Length	<b>44.57 in</b>	Shaft Diameter	<b>3.375 in</b>
Shaft Extension	<b>8.5 in</b>	Assembly/Box Mounting	<b>F1/F2 Capable</b>
Outline Drawing	<b>B-SS620255</b>	Connection Diagram	<b>A-EE7341C</b>

This is an uncontrolled document once printed or downloaded and is subject to change without notice. Date Created: 06/29/2018

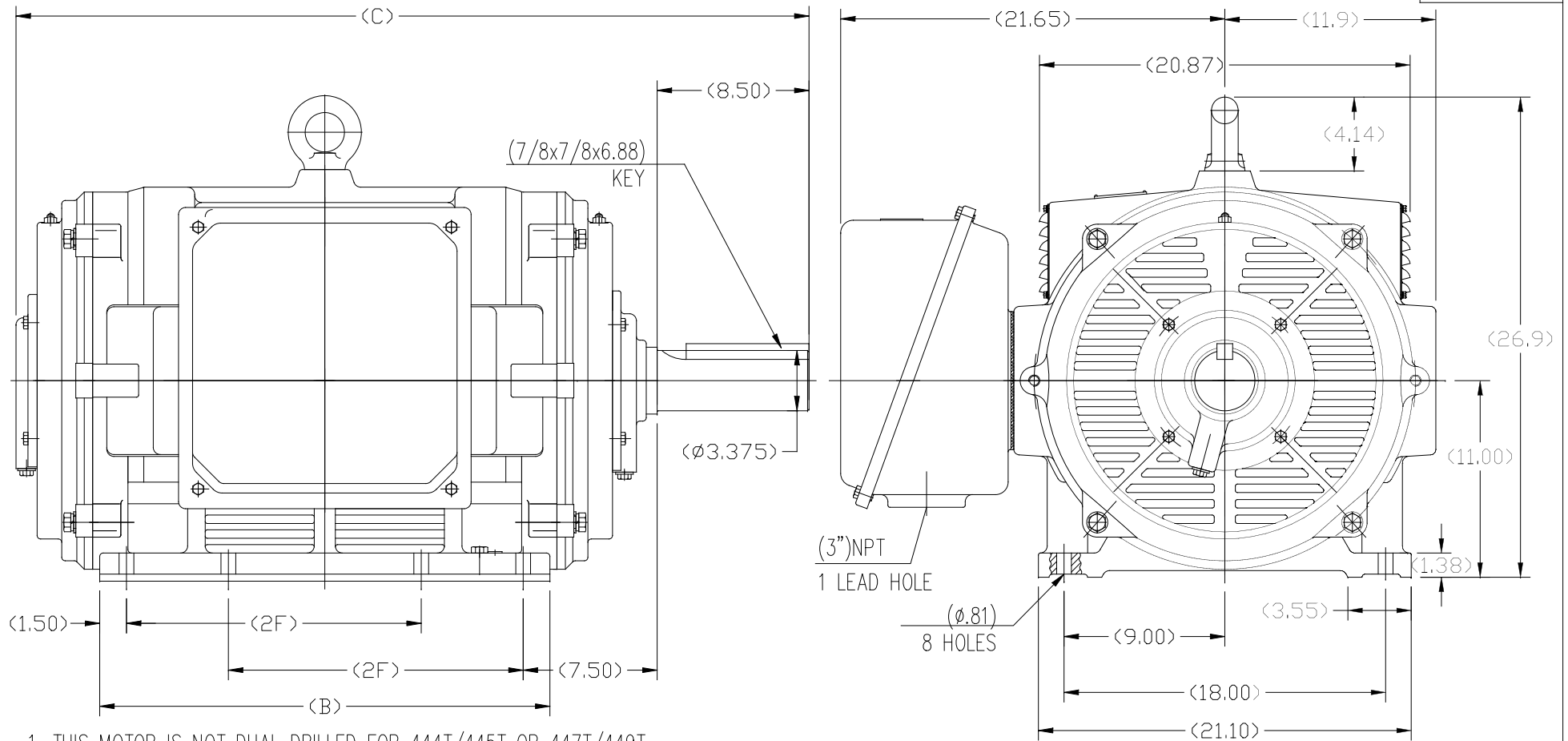

1. THIS MOTOR IS NOT DUAL DRILLED FOR 444T/445T OR 447T/449T
2. THIS MOTOR IS DRILLED FOR F1/F2 CAPABILITY

444T	44.57	25.20	14.50
445T	44.57	25.20	16.50
447T	49.69	30.32	20.00
449T	49.69	30.32	25.00
Frame	C	B	2F

				TOLERANCES UNLESS SPECIFIED				DRAWN ZYH 02-21-2010		
				DEC.	INCHES			CHK HZJ 02-21-2010		
				X	±1	<b>REGAL-BELOIT CORPORATION</b> TITLE 444/445/447/449T FR-ODP-CAST IRON		APPD CL 02-21-2010		
				XX	±.03			SCALE 6=32		
G	UPDATED DRAWING PER MARK-UP ECO-0108274			W/GJ	10-7-16	EMH	XXX	±.005	REF	
A	2 leads hole change to 1			CL	2010-9-8	XXXX	±.0005	MAT'L.	FNF HWADA	
NO.	REVISION			BY & DATE	CHK	ANG	±1/2	FINISH	PREV	
THIS DRAWING IN DESIGN AND DETAIL IS OUR PROPERTY AND MUST NOT BE USED EXCEPT IN CONNECTION WITH OUR WORK ALL RIGHTS OF DESIGN AND INVENTION ARE RESERVED THIS IS AN ELECTRONICALLY GENERATED DOCUMENT - DO NOT SCALE THIS PRINT				RFP	CAD FILE SS620255			SIZE B	DRAWING NO. SS620255	REV. G
				DIST						

EE7341C

THREE PHASE – PART WINDING START  
DELTA – 6 LEADS

START

- CONNECT T1 TO LINE 1
- CONNECT T2 TO LINE 2
- CONNECT T3 TO LINE 3
- T7–T8–T9 OPEN

RUN

- CONNECT T1&T7 TO LINE 1
- CONNECT T2&T8 TO LINE 2
- CONNECT T3&T9 TO LINE 3

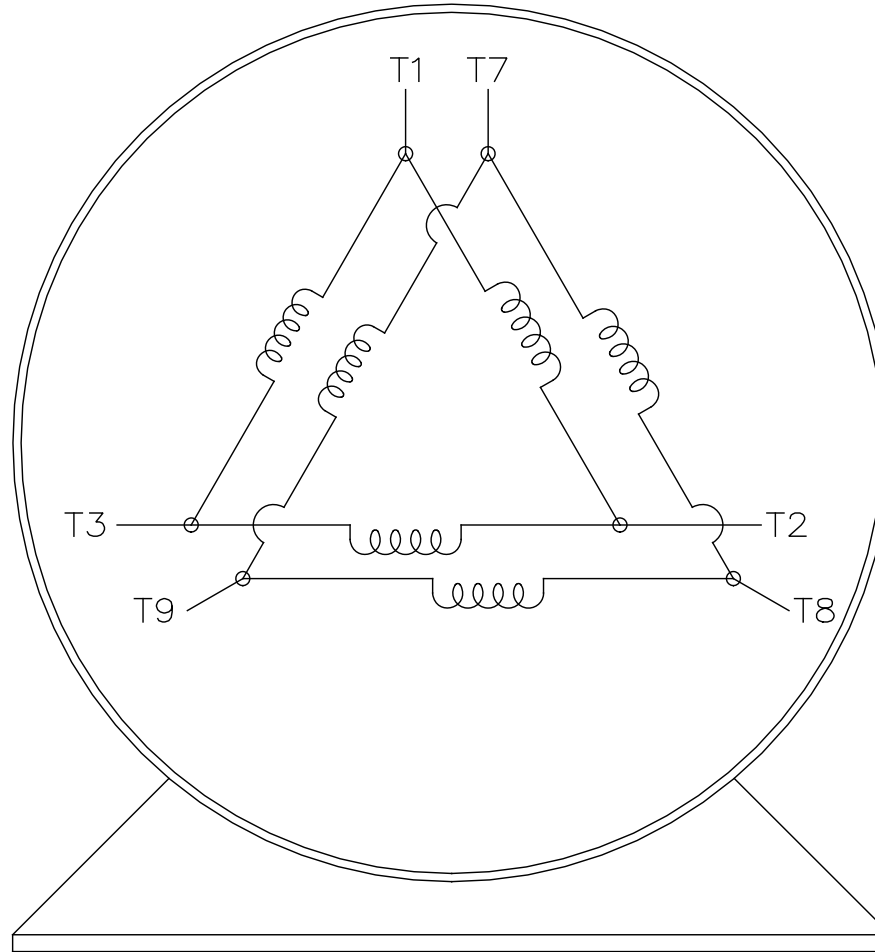

VIEW OF TERMINAL END

		TOLERANCES UNLESS SPECIFIED		<b>REGAL - BELOIT CORPORATION</b>		DRAWN/BLR 03-09-1998						
		DEC.	INCHES			CHK	ML	03-23-1998				
		.X	± -			APPD	GK	03-23-1998				
		.XX	± -			TITLE		SCALE	1=1			
			.XXX	± -	CONNECTION DIAGRAM		REF					
					3Ø – 6 LEADS		FMF					
D	RE-DRAWN WITH REGAL LOGO ECO-0110493	WGJ 09-30-2016	EMH	.XXXX	± -	MAT'L.	PREV					
NO.	REVISION	BY & DATE	CHK	ANG	± -	FINISH						
THIS DRAWING IN DESIGN AND DETAIL IS OUR PROPERTY AND MUST NOT BE USED EXCEPT IN CONNECTION WITH OUR WORK ALL RIGHTS OF DESIGN AND INVENTION ARE RESERVED THIS IS AN ELECTRONICALLY GENERATED DOCUMENT – DO NOT SCALE THIS PRINT						RFP	CAD FILE EE7341C	SIZE	DRAWING NO.	PAGE	OF	REV.
						DIST		A	EE7341C			D



Data Sheet

Date: 6/20/2017

44STTDC16076

Customer:



Submital

Attention:

FAREEDA DUDEKULA

Data @ 460 V

Submitted by:

Motor Load Data

Load	0%	25%	50%	75%	100%	115%	125%	LR
Current (Amps)	42.5	54.0	80.0	110	145	166	182	907
Torque (ft-lb)	0.00	137	275	413	552	636	692	1,025
RPM	1200	1198	1195	1192	1190	1,188	1186	0
Efficiency (%)		92.4	95.0	95.0	95.0	95.0	94.5	
P.F. (%)	5.0	58.0	77.0	84.0	85.0	86.0	86.0	34.0

Motor Speed Data

	LR	Pull-Up	BD	Rated	Idle
Speed (rpm)	0	700	1150	1190	1200
Current (Amps)	907	800	450	145	42.5
Torque (ft-lb)	1,025	825	1,300	552	0.00

Information Block

HP	125.0			
Sync. RPM	1200			
Frame	445			
Enclosure	DP			
Construction	TDC			
Voltage	460#380 V			
Frequency	60 Hz			
Design	A			
LR Code letter	G			
Service Factor	1.15			
Temp Rise @ FL	55 °C			
Duty	CONT			
Ambient	40 °C			
Elevation	1,000 feet			
Rotor/Shaft wkt	88.0 Lb-Fe			
Rel Wdg	CHT44560002 NONE			
Sound Pressure @ 1M	78 dBA			
VFD Rating	VARIABLE 10:1			
Outline Dwg	B-SS620255			
Conn. Diag	A-EE7341C			
Additional Specifications:				
EQUIV CKT (OHMS / PHASE)				
R1	R2	X1	X2	Xm
0.0280	0.0150	0.1860	0.3000	6.2310

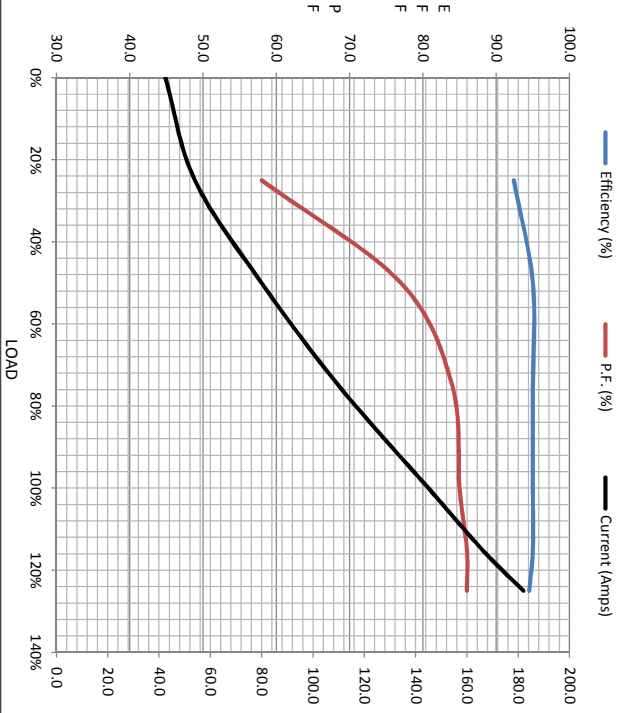

Speed - Torque Curve

